

AIDA 07/05/2009

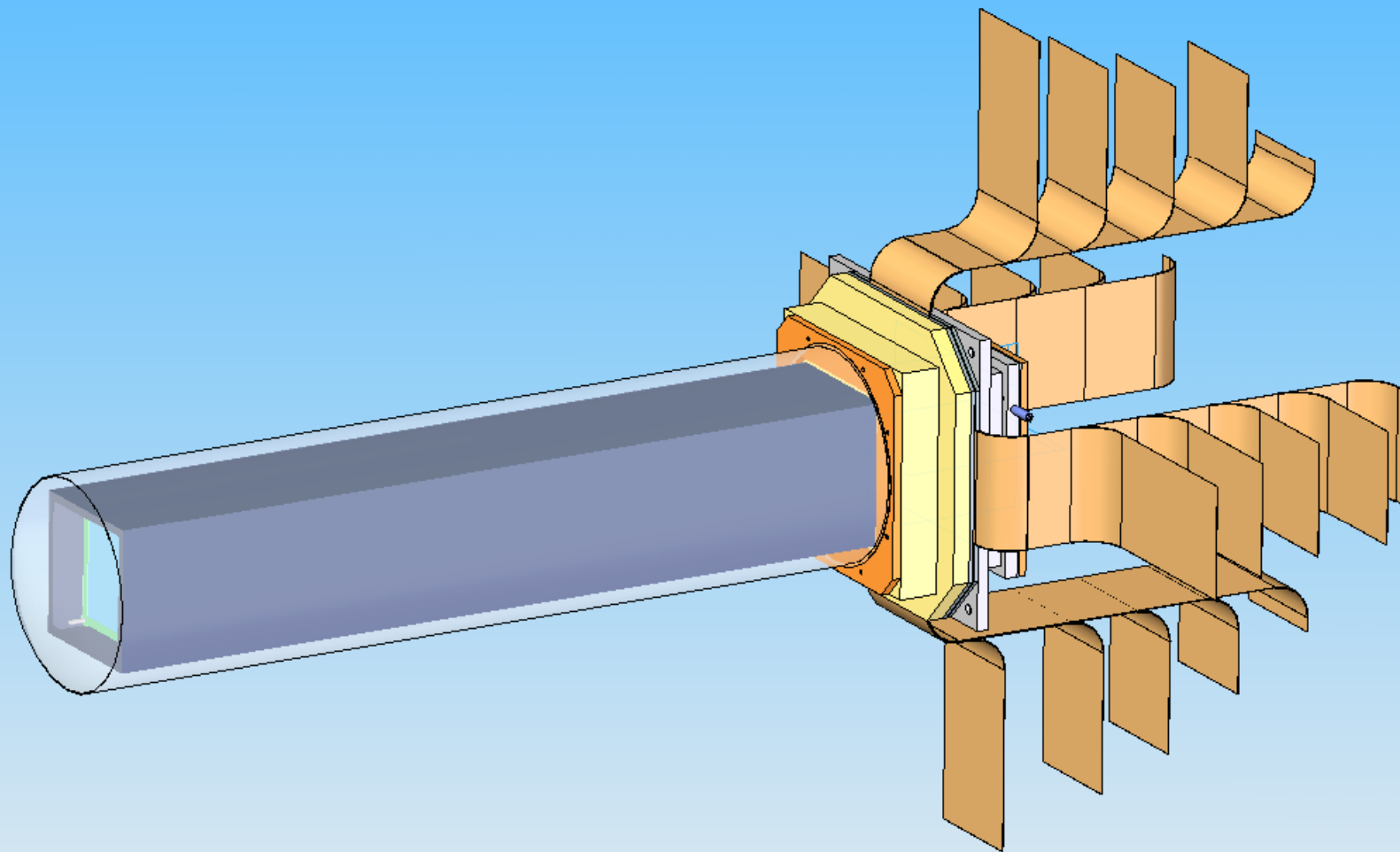

AIDA 07/05/2009

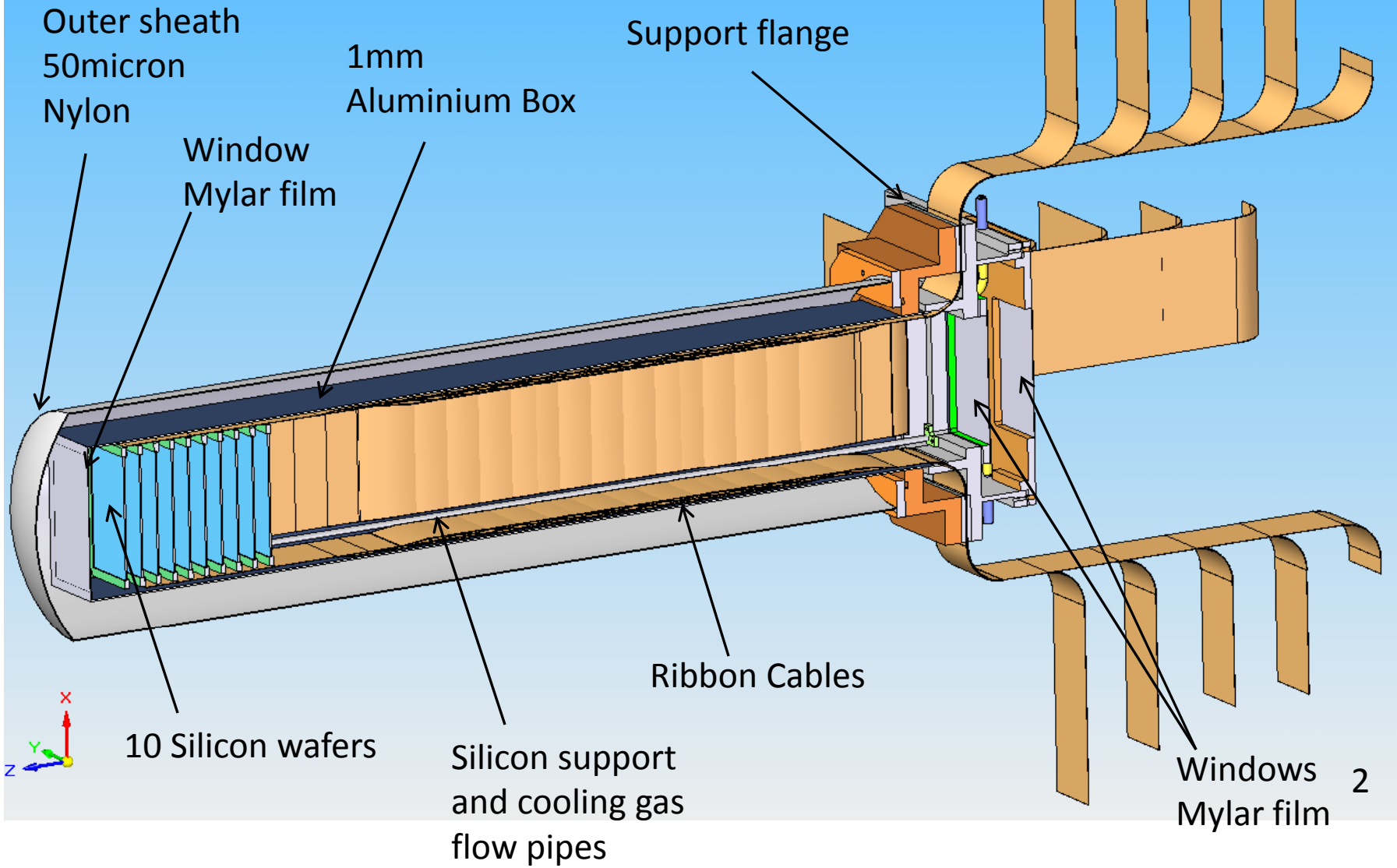

AIDA 07/05/2009

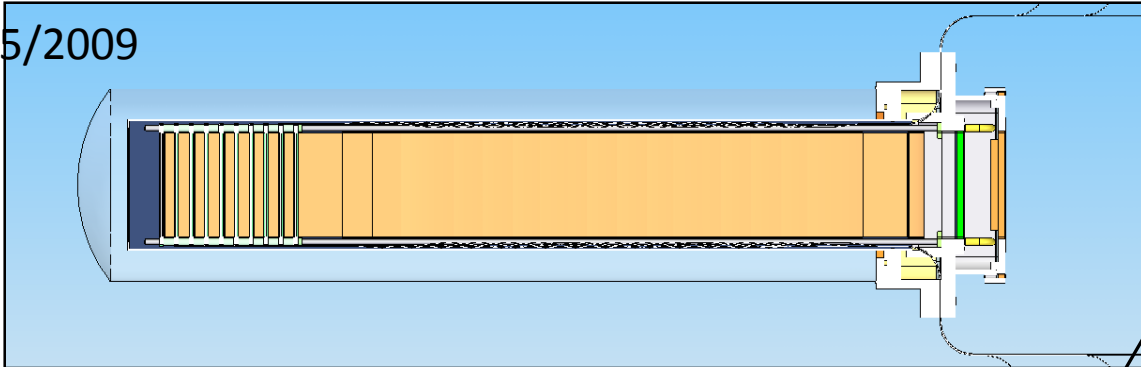

Plastic

Stainless Steel

Volume flooded with N2 at 0 degrees for cooling

Volume flooded with N2 at 20 degrees for thermal insulation

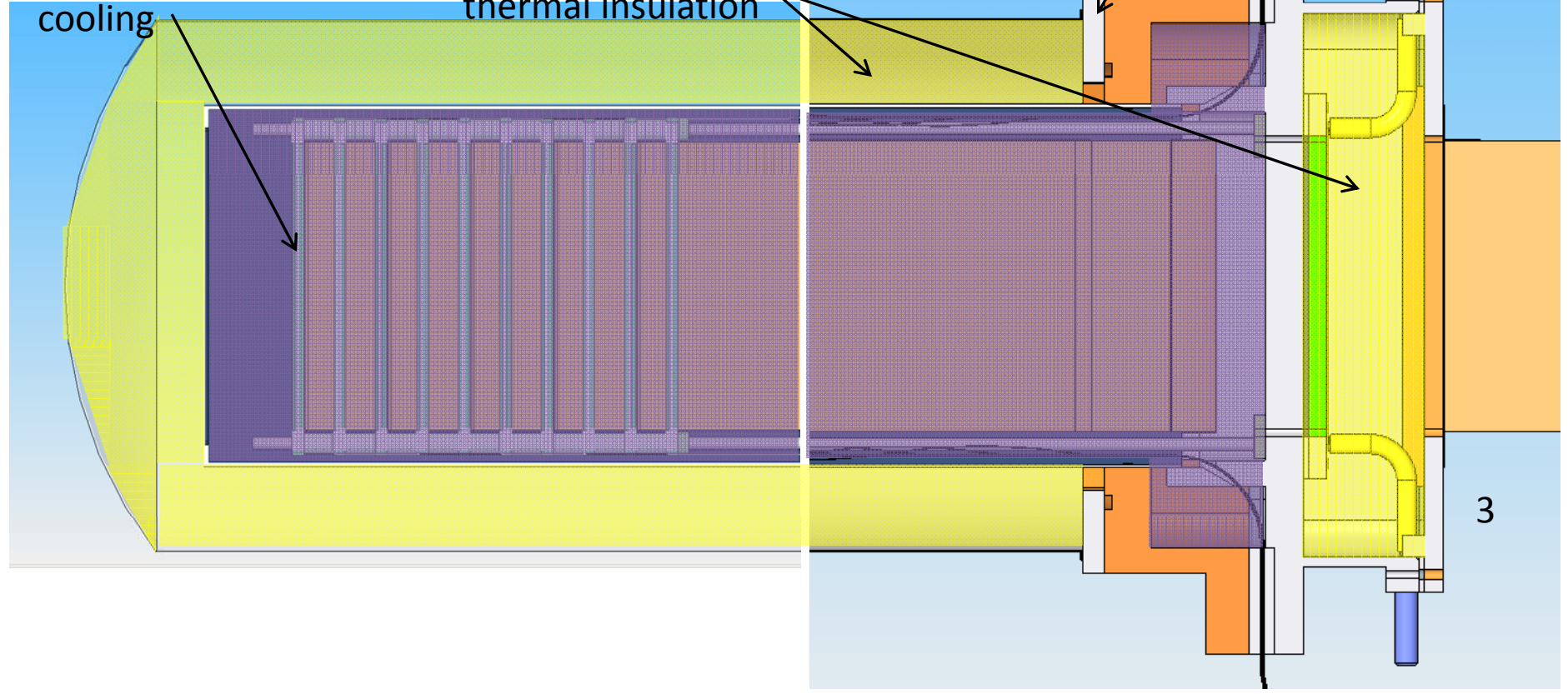

AIDA 09/06/2009

Mylar liner
wrapped round
pipes to guide
gas flow

Plastic window
spacer added

Component
split in two and
lengthened (this
part plastic)

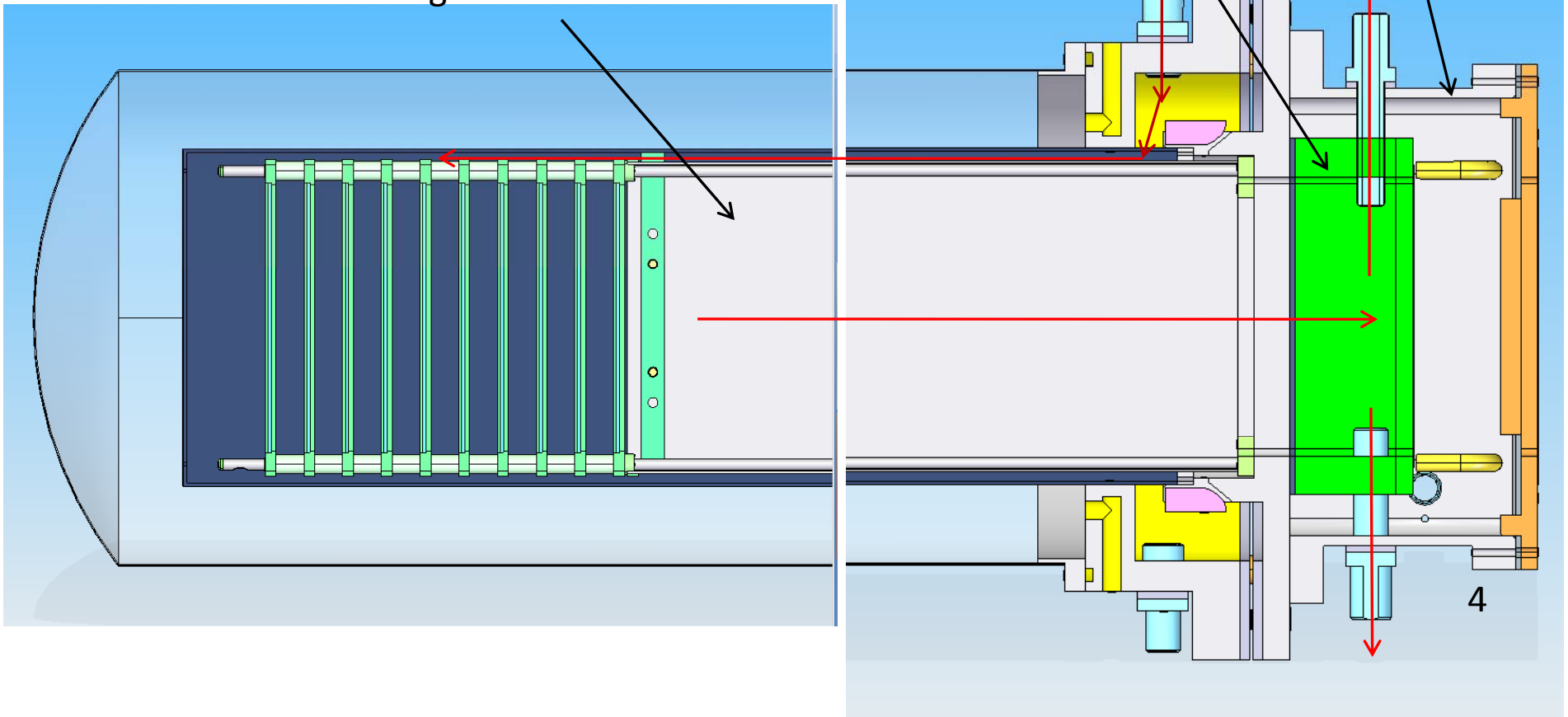

Additional possibilities:
Mylar box around circuit boards with holes drilled through boards

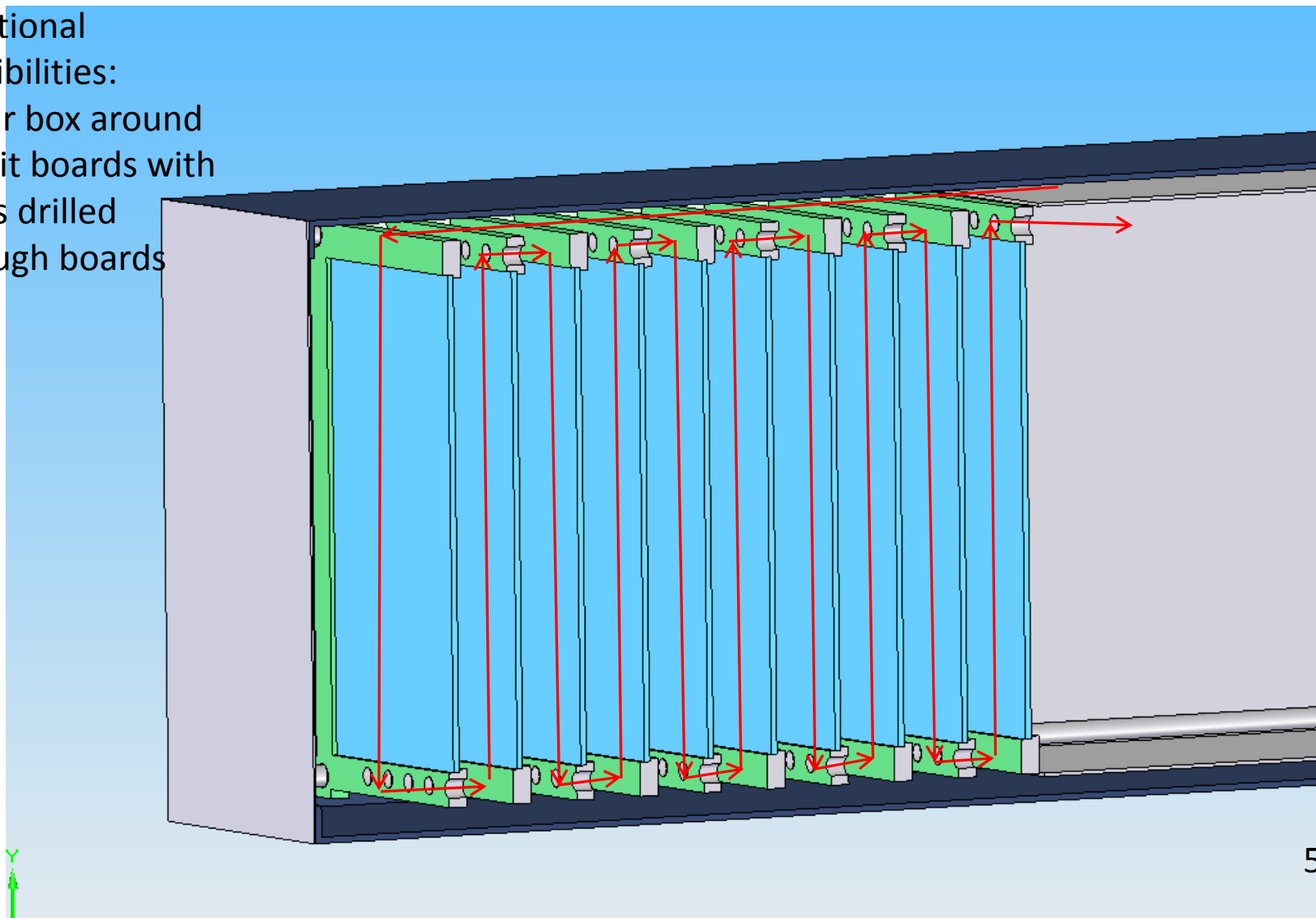

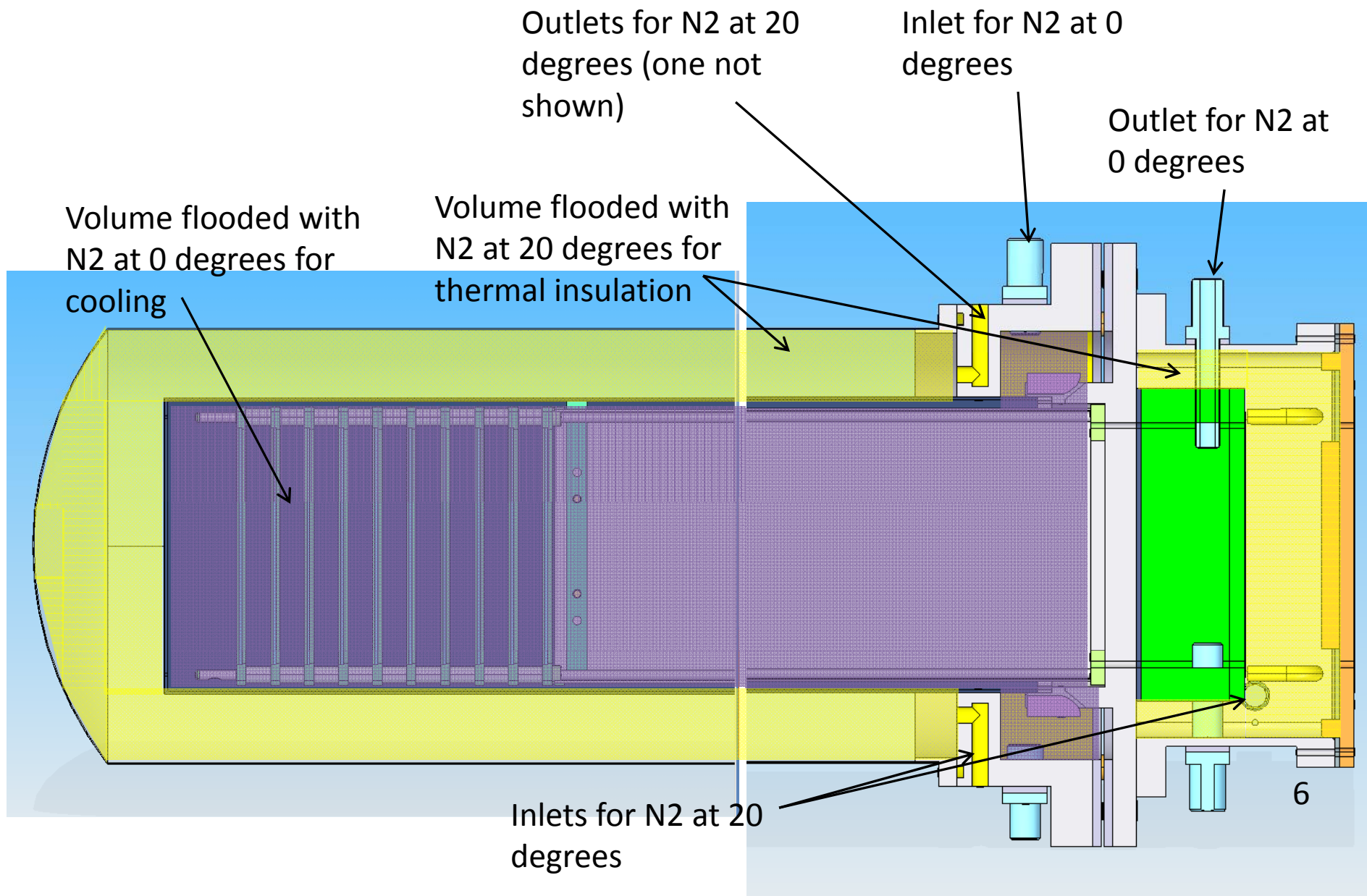

Aluminium Box

Machining method.
Buy std Al extrusion
Machine outside.
Use spark erosion for
internal profile.

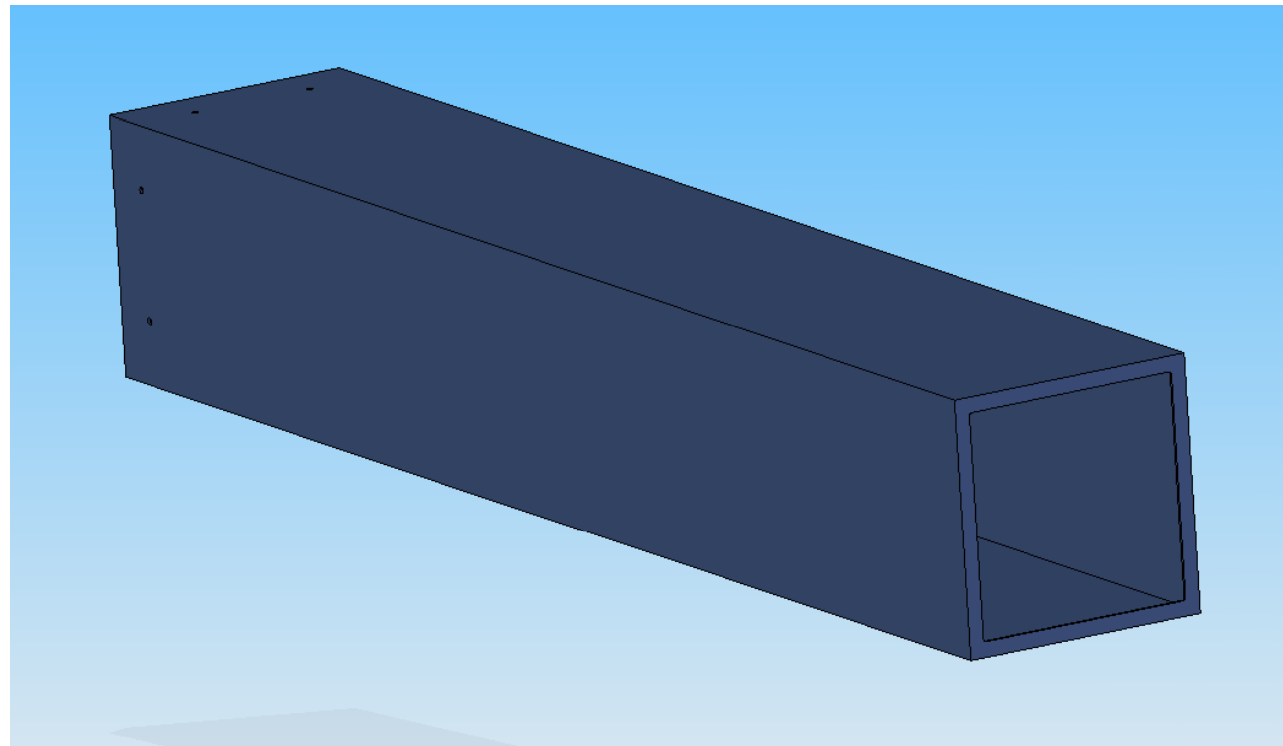

Fabrication method.
Make 2 L shapes and
weld together.
HAZ
Tack or Stitch.
Varying thickness on
edge

Bonding method.
Make 2 L shapes and
bond together.
Varying thickness on
edge
May be issues with
conductivity between
plates

Should the part be
allochromed?

Plan

